

Written by our in-house team of artists, our blog is an invaluable resource designed to inform your creative process. From artist interviews to in-depth technical advice, you can find this ever-growing treasure trove at [jacksonsart.com/blog](https://www.jacksonsart.com/blog)

Facebook: @JacksonsArt | Instagram: @jacksons\_art  
Pinterest: jacksons\_art | Twitter: @jacksons\_art  
YouTube: Jackson's Art

---

# A-FRAME EASEL

---

## ASSEMBLY GUIDELINES

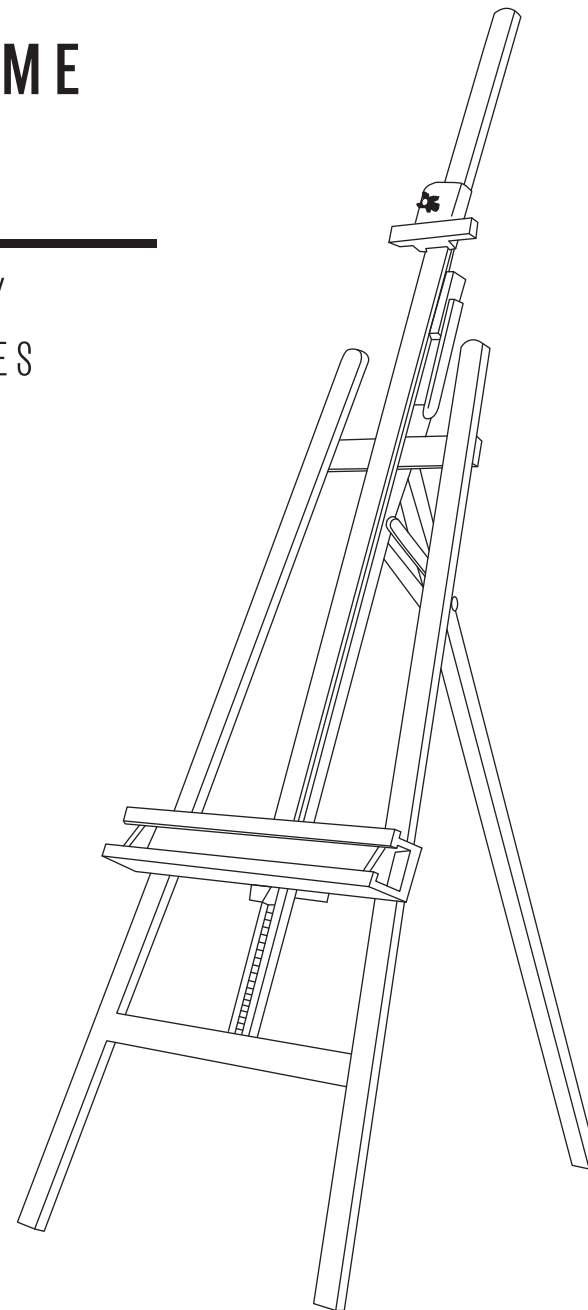

1

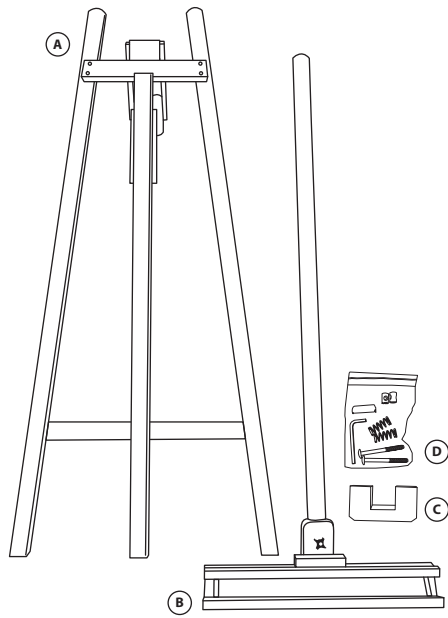

Take easel out of the packaging, and unwrap all elements. You should have four units in total.

2

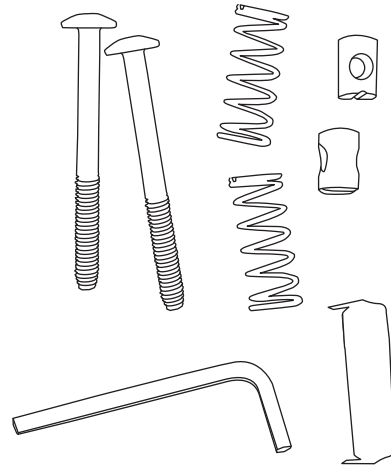

In the bag (D) you will find these elements: 2x screws, 2x springs, 2x barrel nuts, an Allen key and a cover plate.

3

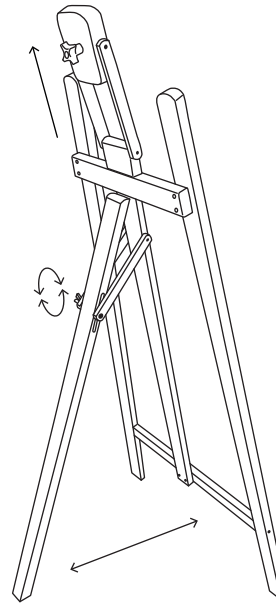

Place the easel upright on its feet and adjust the rear leg to the preferred angle while ensuring the easel is stable. Use the back the screw to tighten the easel into position.

4

**REMINER**  
Place the cover on top of the bolt near the sliding head before placing the bottom support.

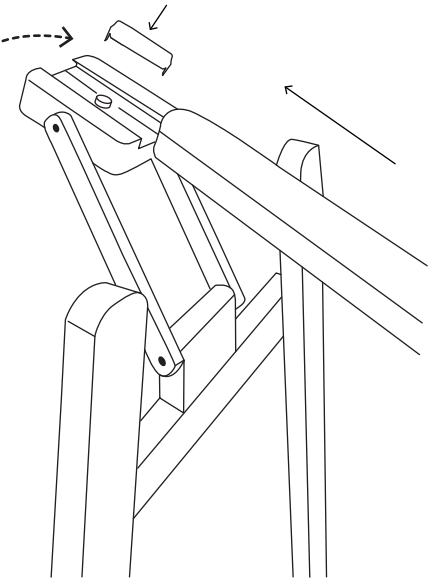

Place the support central mast (B) next to it the easel and slide it through the flexible head (A).

5

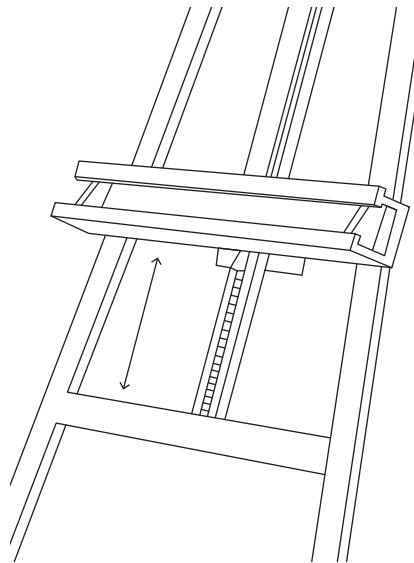

Adjust the lower canvas support bar (B) by moving it up or down to find the right height for your canvas/surface.

6

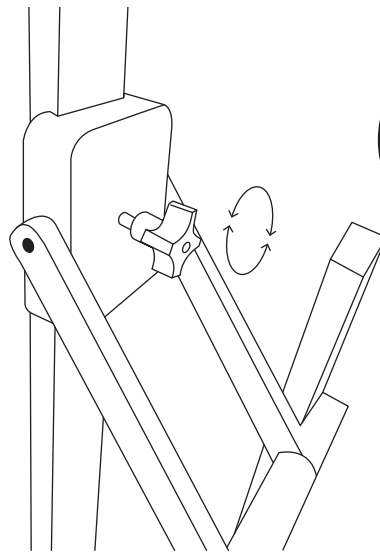

Tighten the back screw on flexible head to lock the central mast (B).

7

**REMINER**  
Place the barrel nut (oval side up) from bottom opening, with the barrelhole facing the U-bar.

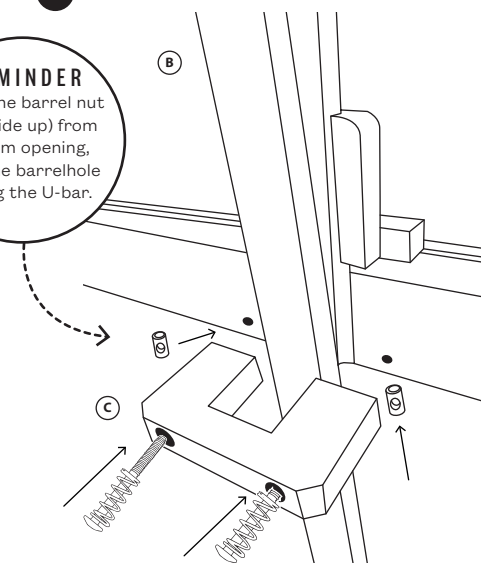

Place U-BAR (C) to secure the easel support central mast (B), then insert the screws with the springs. The screws need to be screwed onto the barrel nuts.

8



Place your canvas on the support and adjust the top clamp to the correct height. And now, paint away!